



# 1107961

---

User's Manual

Edition 4.0  
2009/12/03

## 5-Slot PICMG 1.3 PCIe to PCI Bridge Backplane User Manual Ver. 4.0

### 1. USB1, USB2: External 4 Port USB Connectors From the Mainboard

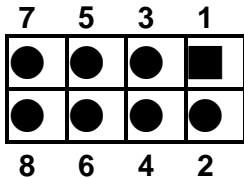

PIN	DESCRIPTION	PIN	DESCRIPTION
1	USBVCC	2	GND
3	DATA-	4	DATA+
5	DATA+	6	DATA-
7	GND	8	USBVCC

### 2. FAN1, FAN2, FAN3, FAN4: Fan Connector

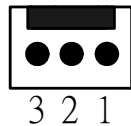

PIN	DESCRIPTION
1	GND
2	+12V
3	NC

### 3. ATXCTL1: Backplane to Mainboard ATX Power Control Connector

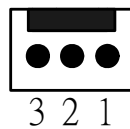

PIN	DESCRIPTION
1	GND
2	PSON#
3	5VSB

### 4. PWRBTN: Power On Button

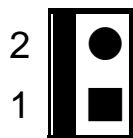

PIN	DESCRIPTION
1	GND
2	PWRBT#

### 5. RESET: Reset Button Connector

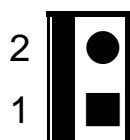

PIN	DESCRIPTION
1	GND
2	SHB_RST#

## 6. PWRGD: Power Good Connector

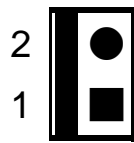

PIN	DESCRIPTION
1	GND
2	PWRGD

## 7. SM-BUS: System Management BUS Connector

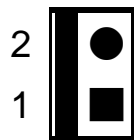

PIN	DESCRIPTION
1	SMDAT
2	SMCLK

## 8. CN1: PCIE X16 SDVO Control Signal Pin

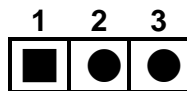

PIN	DESCRIPTION
1	EXP_EN
2	SDVO_CLK
3	SDVO_DAT

## 9. IOPWR: The I/O Power Connector indicators for controlling your CPU board

PIN	DESCRIPTION	PIN	DESCRIPTION
1	GND	2	-12V
3	+12V	4	GND
5	IPMB DA	6	5VSB
7	GND	8	GND
9	IPMB_CL	10	5VSB
11	+5V	12	PWRGD
13	SMDAT	14	SHB_RST#
15	5VSB	16	GND
17	SMCLK	18	PSOEN#
19	+3.3V	20	PWRBT#

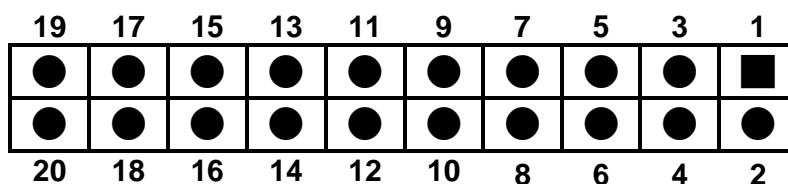

**10. PCI routing table:**

<b>SIGNAL</b>	<b>REQ#</b>	<b>GNT#</b>	<b>IDSEL</b>	<b>INTA#</b>	<b>INTB#</b>	<b>INTC#</b>	<b>INTD#</b>
<b>PIN No.</b>	<b>B18</b>	<b>A17</b>	<b>A26</b>	<b>A6</b>	<b>B7</b>	<b>A7</b>	<b>B8</b>
<b>PCI1</b>	0	0	AD31	B	C	D	A
<b>PCI2</b>	1	1	AD30	C	D	A	B

**11. Notice:**

- a. Recommend to use 6mm width spacer to install**

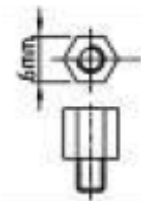

- b. Torsion must less than 6lb-inch**

## 12. Dimension:

